



Takahe 8 Air Family Tent
Model No. KC072-710

PITCHING INSTRUCTIONS

Your tent includes:

- 57 x pegs (6mm D x 250mm L)
- 24 x ropes
- 4 x Black PORCH poles (1900mm x 16mm)
- 1 x hand pump

1. Select a dry, level site and clear the ground of any sharp objects. Remove the tent, pegs and pump from the carry bag. Untie fabric ties and unroll the tent.
2. Spread out the floor of the inner tent and peg out the four main corners first, then peg out the four corners of the middle room. Ensure that the tent is pulled taut and square. Peg out the vestibule and all remaining pegging points. Unzip and open the doors to make erecting the tent easier. Pitch the inner so it is in line with the wind, never side on.
3. Attach the pressure restrictor to the hand pump. Begin with the central air tube. An external valve is located on each air tube at the back side of the tent. The central air tube is a single connected air tube with two external valve points. To inflate correctly, close-off one valve point and inflate the other. Screw a valve cap into the air tube and then unscrew the valve cap on the top.

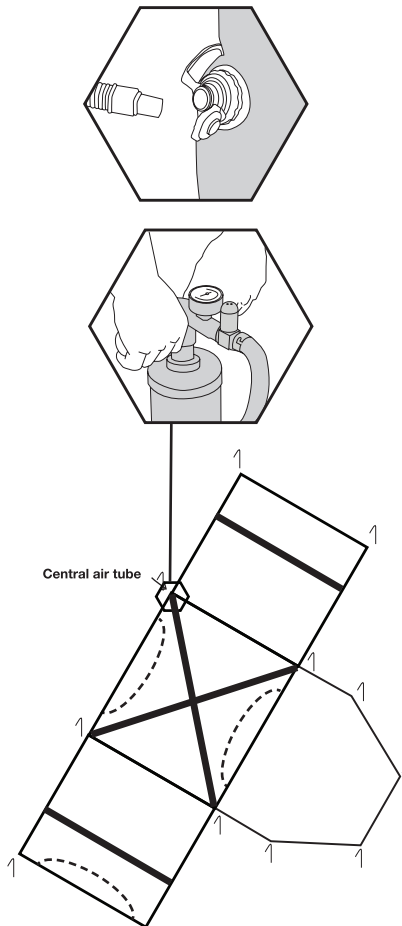

To make sure the tent stays in place insert the pegs into the ground at a 45° angle, not straight down.

4. Inflate the remaining air tubes. Adjust the base of each air tube so it sits flat with the ground. Secure at the base with the hook and loop tabs.
5. It is recommended in hot weather that 6psi is used to allow for the air to expand inside the air tubes. In cooler/windier conditions 8psi is recommended. Please adjust the pressure in the air tubes as the ambient temperature changes. Only use the hand pump provided as it has a pressure gauge which shows the recommended pressure (psi).
6. Carefully pull the fly over the inner, making sure the windows and doors line up. Attach the fly to the topmost air tubes with the hook and loop tabs and follow with the lower tabs. Attach the base of the middle room with the four side release buckles. Proceed to peg out the pegging points on the fly ensuring there is an adequate gap between the inner and the fly.

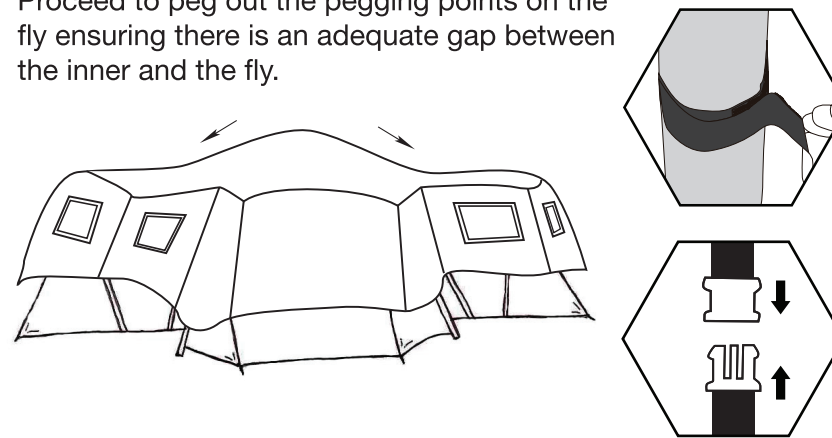

7. To pitch the vestibule, locate the air tube attached to the fly. Inflate the vestibule air tube and ensure it sits flat with the ground.
8. Proceed to attach the side release buckles, and tighten if necessary. Peg out any remaining pegging points on the fly.

9. Finally, rope out the guy ropes and fine-tune the fly so it remains taut and positioned correctly over the tent.
10. When pegging out the black PORCH poles, make sure the ropes are at a 45° angle to pull the flap evenly. In light rain, you can remove the middle section to allow any water build-up to run off. In heavy rain, you may have to pull the flap down.

Please read the care instructions for more product information about your tent.

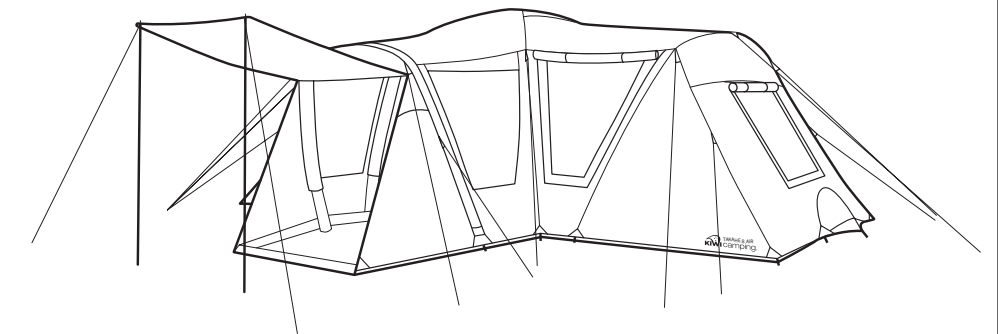

REVERSE THE PROCEDURE TO LOWER THE TENT

PACKING INSTRUCTIONS

Release all guy ropes. Unzip the doors and windows and remove the fly. Evenly lay out the dry fly inside the tent inner (this is best done when the inner is still pitched) leaving all doors and windows open. Unscrew the air tube valve caps to release the air in the air tubes. Ensure all the air escapes. Once deflated, remove all of the pegs and side release buckles. Fold the tent in half so that the air tubes lay on top of each other. Ensure that the air valves are not obstructed to allow the remaining air to escape. Force out the remaining air by pressing down on the air tubes, working toward the air valve from the furthest point. To reduce the chance of valve malfunction, unscrew the valves fully while the product is in storage.

Ensure the tent is completely dry and clean before storing away and store it in a dry environment.

TENT CARE INSTRUCTIONS

PLEASE READ ALL OF THE TENT CARE INFORMATION AND INSTRUCTIONS INCLUDED WITH THIS TENT BEFORE USING YOUR TENT FOR THE FIRST TIME.

1. Before you use your new tent, fully unpack and pitch it at home. It is important to familiarise yourself with the set-up procedure and the various features.
2. Select a site that is level, clear of any sharp objects, is dry, will drain well if it rains and is protected from wind and other elements.
3. Keep clear of overhead power lines and trees when setting up your tent.
4. For best and easiest results, enlist the help of at least one other person to assist in pitching the tent.
5. Keep all flame and heat sources away from this tent fabric. Do not use open flame or gas appliances in or near your tent.
6. Do not use aerosol sprays or any solvent-based products in or around your tent as these could damage the fabric or special coatings. These products include but are not limited to: repellent spray, hair sprays, alcohol, detergents, fly spray, petrol, kerosene etc.
7. Please note, the warranty on this tent will be deemed void if the product is used for any purpose other than a **temporary, recreational** use shelter.
8. DO NOT leave tent pitched for weeks at a time as extended exposure to the sun's ultraviolet rays can damage and/or cause it to discolour. Your tent will not be covered under warranty if you leave it up for many weeks at a time. To avoid the risk of UV deterioration, site the tent in a shaded area, where it will be protected from exposure to strong sunlight.
9. Especially in windy conditions, it is essential that you attach guy ropes and fasten them to the ground. We suggest you insert the pegs into the ground at a 45° angle towards the tent, not straight down. Please note, your tent will not be covered under warranty if wind damage occurs.
10. Use all of the guy ropes and pegs included to ensure your tent is secure and to prevent damage to both yourself and the tent. Check guy ropes/pegs daily.

11. When closing the doors, hold the flaps up to take pressure off the zips. Ensure that the tent fabric is never overstretched, especially as this may cause problems with the internal doors.
12. To clean your tent, only ever use a soft sponge and warm water. DO NOT use excessive force or other harsh cleaners to remove marks from tent.
13. Ensure the tent is completely dry and clean before storing away and ensure to store it in a dry environment.
14. Please note that the valves used on this product rely on a good air seal which can fail and become ineffective if left under compression whilst in storage. To reduce the chance of valve malfunction, the valves should be fully unscrewed when the product is in storage. Replacement valves are available from your stockist.
15. Punctured air tubes can be repaired using Tear Aid B. For information on how to repair a puncture, see the ***Kiwi Camping Air Tube Repair Tutorial***. Spare air tubes are available to purchase from your stockist.
16. Changing atmospheric conditions can make the air tubes appear to lose or gain pressure. This is commonly caused by rising or lowering ambient temperature. Should this occur, the air tube will simply require either a top-up or release of excess pressure. We recommend occasionally checking the pressure throughout the day to ensure it is the correct psi. It should NOT be considered a sign of leakage or puncture. However, where leakage is suspected, you should first inspect the valve to ensure that no parts are cross-threaded and that the air seals are in good condition and tight. Removing a valve and then re-fitting and re-inflating may help.

IMPORTANT:

1. Under certain conditions (cold weather, high humidity etc.) condensation may form on the inside of your tent fly. Condensation can occur for many reasons including vapour from your breath, perspiration, cooking nearby or wet clothing inside your tent. This does NOT mean your tent is leaking through the fabric. You can minimise condensation by opening windows and airing out your tent during the day and by removing any wet clothing/towels etc.

2. Try to avoid pitching your tent under trees as tree limbs, falling leaves, sap, bird droppings or excess water dripping from the trees can cause damage to the tent fabric and its special coatings resulting in leakage or discolouration.
3. Only remove the tent pegs by pulling on the peg itself. NEVER pull on the tent or the webbing loops to remove pegs as it could result in damage to the tent or personal injury.
4. DO NOT leave tent pitched for weeks at a time as extended exposure to the sun's ultraviolet rays can damage and/or cause it to discolour. Your tent will not be covered under warranty if you leave it up for many weeks at a time.
5. STORAGE:
NEVER store your tent wet or dirty (even for short periods of time). NEVER store your pegs or poles inside your tent. Always use the separate bags they are supplied in.
6. You may want to insure your tent against loss or damage.

WARRANTY INFORMATION

The warranty period for this tent is found on the packaging and full details are on the Kiwi Camping website - www.kiwicamping.co.nz.

Key points:

The original purchaser of this product is offered a warranty if during this time period the product fails due to a fault in either materials or workmanship. Service under this warranty is available by returning the product, with your proof of purchase, to where it was purchased. If after inspection it is determined that the product is defective, we will repair or replace it (at our discretion) free of charge. This warranty does not cover misuse, damage caused by accident, storm or wind damage, mildew, neglect, UV degradation and fair wear and tear. Please note, the warranty on this tent will be deemed void if the product is used for any purpose other than a temporary shelter. If the claim is not deemed a warranty or is outside its warranty period, we can repair the product at a nominal cost.



Distributed by: Aber Living, Hamilton, NZ
www.kiwicamping.co.nz

5319-09/22